

INSTRUCTIONS D'ASSEMBLAGES ASSEMBLY INSTRUCTIONS

logiflex

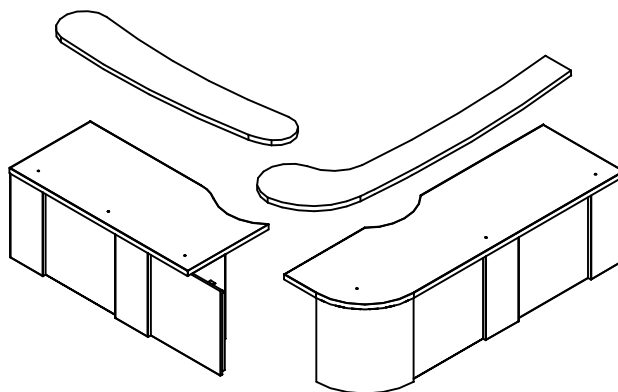

Quincaillerie
Hardware

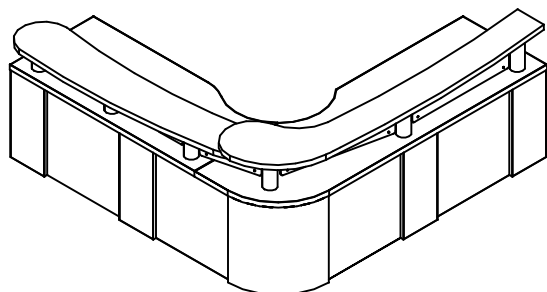
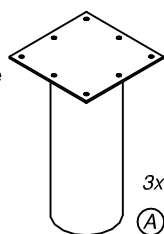

3x
(A)

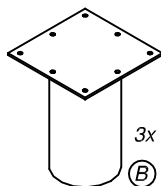

3x
(B)

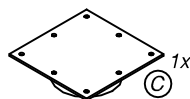

1x
(C)

20x
(G)

20x
(H)



2x
(D)



4x
(E)



6x
(F)

Vis
Screws

$\frac{7}{16}$ "
(I)
2x

1"
(J)
108x

$1\frac{3}{4}$ "
(K)
3x

1.

Assembler le bureau et le retour.
Assemble return to the desk.

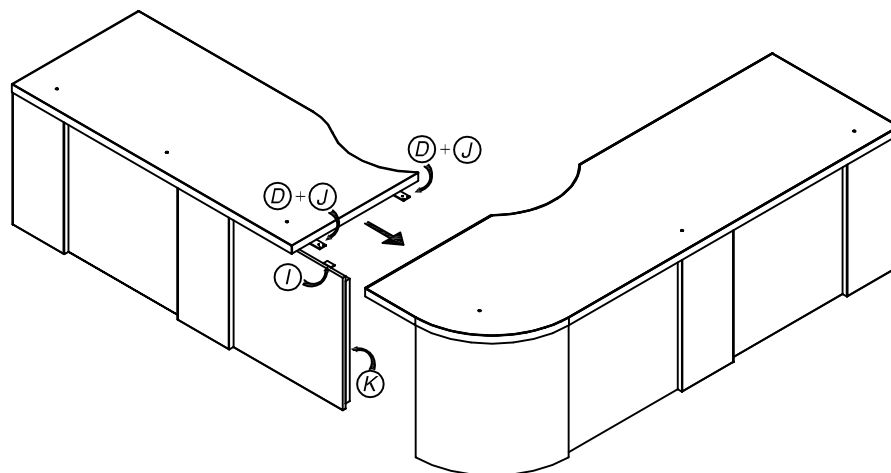

2.

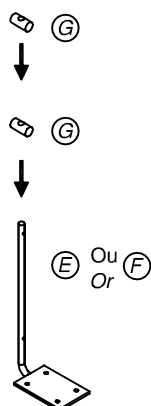

3.

Assembler les tiges en "L" au plexiglass.
Assemble "L" brackets to plexiglass.

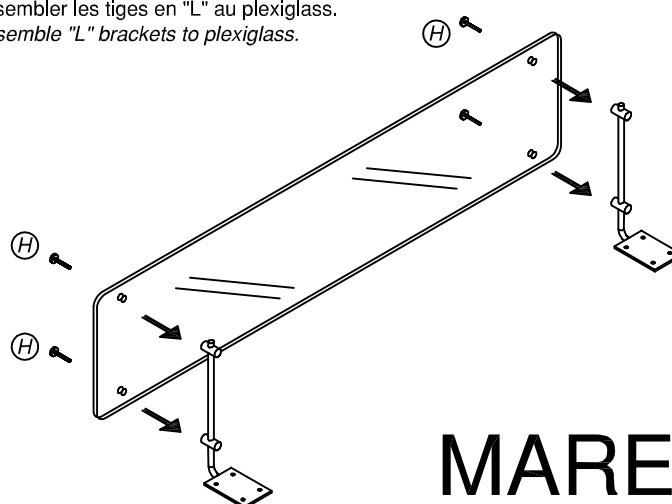

INSTRUCTIONS D'ASSEMBLAGES ASSEMBLY INSTRUCTIONS

logiflex

4.

Retourner les tablettes et assembler les plexiglass aux trous prépercés.
Flip shelves and fix the small post to the predrilled holes.

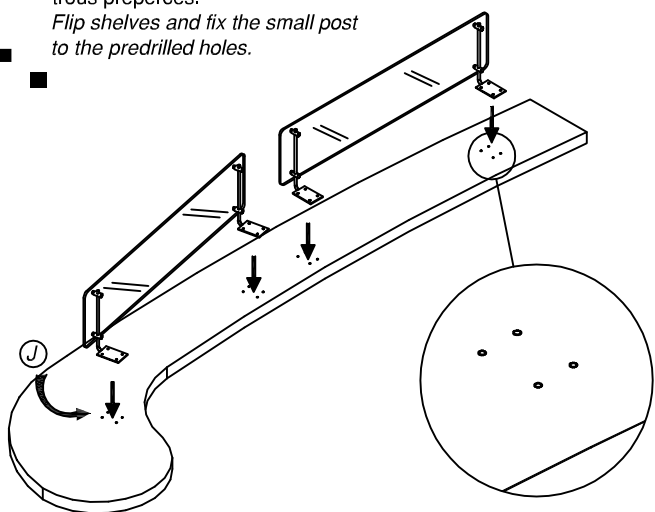

5.

Assembler le petit poteau à la tablette de transaction.
Fix the small post onto shelf.

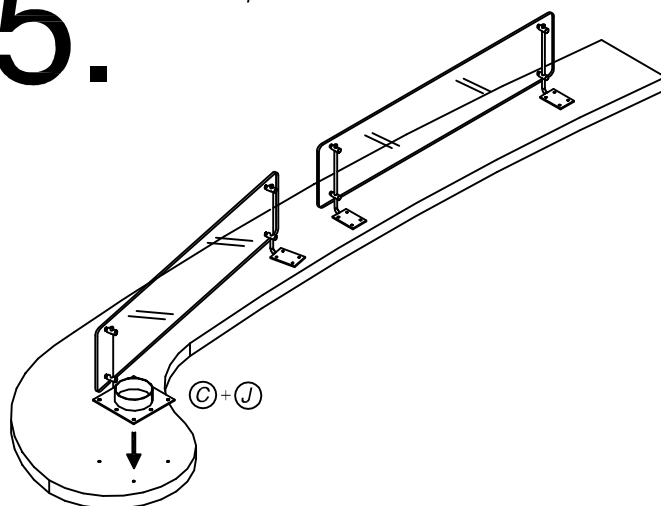

6.

Installer les poteaux au bureau et retour.
Install posts onto desk and return.

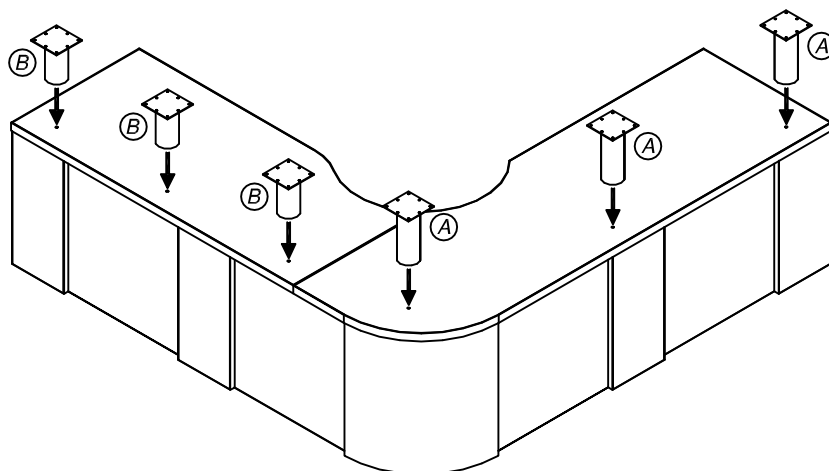

7.

Installer les tablettes de transaction et les plexiglass aux poteaux de réception.
Install shelves with plexiglass onto reception posts.

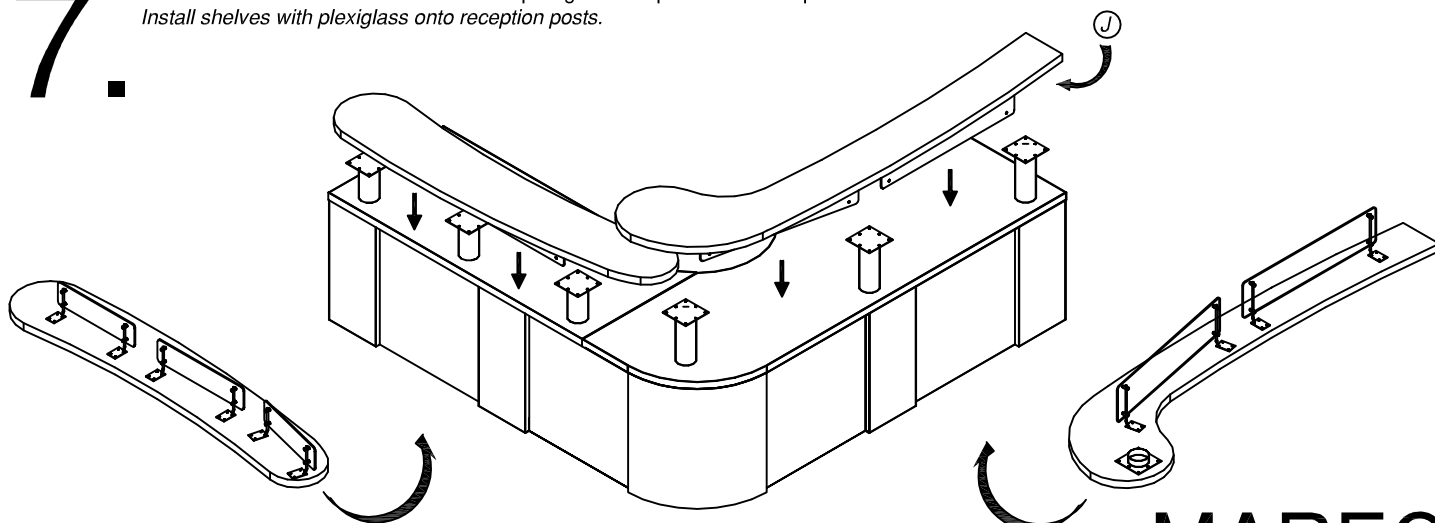

MAREC