

Typical Layouts

elevation-c005

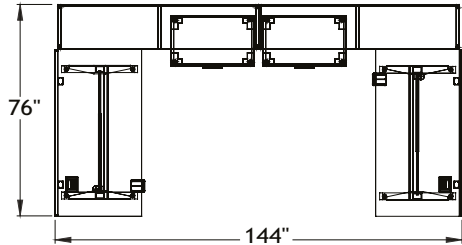

Laminate: Ginger Root
 Metal : Black
 Fabrics: Mayer Fabrics - Fedora Topaz and Plum

Note: Fabrics are specified for informational purpose only and may be of different grades. Typical pricing is based on grade 2 fabric.

ITEM	QTY	CODE	DESCRIPTION	LIST PRICE \$	TOTAL \$
A	1	EL 3060 BAS BL NGR	Rectangular desk 30" x 60" x 27"/47"H	1 561	1 561
	1	[MH3D L]	Option - Connectivity unit - 1 power and 2 USB	364	364
B	1	LV 167242 UN23 C	Leg base storage 16" x 72" x 42"H	553	553
	1	[MGRR]	Option - Leg grommet	24	24
C	1	LV 167242 UN23 C	Leg base storage 16" x 72" x 42"H	553	553
	1	[MGRL]	Option - Leg grommet	24	24
D	1	EL 3060 BAS BL NGR	Rectangular desk 30" x 60" x 27"/47"H	1 561	1 561
	1	[MH3D R]	Option - Connectivity unit - 1 power and 2 USB	364	364
E	2	LV 1830 K25 CHR	High pedestal 18" x 30" x 25"H	1 231	2 462
F	2	LV 2460 UBC CHR	Tackboard 24"H x 60" - Grade 2	595	1 190
				TOTAL:	8 656
				Price per individual desk	4 328

Electrical Accessories

1	84 SB2 120	Starter cable with hardwire, 120" long	246	246	
2	WM44 18	Power and data cable support 4 simplex / 4 circuit, 18-1/2" long	347	694	
1	84 FF 108	Junction cable, 108" long	247	247	
2	WF55	Fabric sleeve for wires - Grade 2	193	386	
1	8SR	Simplex removal tool	5	5	
				TOTAL:	1 578