

# CHAIRS

Price List  
USA 2020



logiflex

# Table of Contents

Introduction	3
Update Summary	4
Product Map	5
Conditions of Sale	6
How to Use the Price List	7
Appendix A: COM Fabric	8
Task Seating	10
Alpha	11
Amigo	13
Axis	15
Cyrus	17
Suavo	21
Accessories	23
Mechanisms	24
Arms	26
Miscellaneous Accessories	27

---

# Introduction

## Update Summary

The February 1, 2020 revision of the Chairs price list presents these principal modifications:

DATE	SECTION	MODIFICATIONS
February 1, 2020	All the Price List	<ul style="list-style-type: none"> <li>All prices have been increased by 2%.</li> </ul>
	Accessories	<ul style="list-style-type: none"> <li>E and EXT mechanisms are no longer available for A61 arms;</li> <li>EF mechanisms are now available for A61 arms.</li> </ul>

Previous updates:

DATE	SECTION	MODIFICATIONS
September 20, 2019	All the Price List	<ul style="list-style-type: none"> <li>Information correction on the number of yards required on COM fabric charts</li> </ul>
June 1, 2019	All the Price List	<ul style="list-style-type: none"> <li>All prices in the Chairs price list have been adjusted between -11 % and 36%.</li> </ul>
	Suavo Chairs	<ul style="list-style-type: none"> <li>Elimination of the following Suavo chairs 700 and 701.</li> </ul>
April 12, 2019	Cyrus Chairs	<ul style="list-style-type: none"> <li>Correction on cylinder diameter information: spider base in black (SB) with 3" cylinder or aluminum (AB) with 5.5" cylinder.</li> </ul>
January 1, 2019	All the Price List	<ul style="list-style-type: none"> <li>All prices have been increased by 4%.</li> </ul>
	Cyrus Chairs	<ul style="list-style-type: none"> <li>Correction: Seat slider SS option is not available on Cyrus mid back operator chair, 500YM8340.</li> </ul>
September 25, 2018	Alpha Chairs	<ul style="list-style-type: none"> <li>Correction on the 1404EXTAF pricing.</li> </ul>
	Mechanisms	<ul style="list-style-type: none"> <li>GTL is replaced by GTL-M.</li> </ul>
April 13, 2018	All the Price List	<ul style="list-style-type: none"> <li>Revamp of the entire price list, interactivity added.</li> </ul>
	Chairs	<ul style="list-style-type: none"> <li>Elimination of the following chair models: Lucca, Chianti and Piccolo</li> </ul>

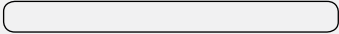

Product Map

Task Seating

Alpha p. 11

Amigo p. 13

Axis p. 15

Cyrus p. 17

Suavo p. 21



## Conditions of Sale

### Prices

The amounts listed in this document are suggested retail prices and may be changed without notice. Applicable taxes are not included. If you have an open and active account with Logiflex, merchandise will be invoiced at the prices prevailing at the time of shipment. A deposit may be requested if the opening of your account has not been completed or if your account has become inactive.

### Terms of Payment

Net 30 days F.O.B. Sherbrooke, Quebec. The invoice will be assigned the shipping date and is payable 30 days from that date. Logiflex remains the owner of the merchandise until the invoice is paid in full.

### Customized Products (Special Items)

Price requests for customized products or special items can be submitted via the "[Private Space](#)" section of our website, at [www.logiflex.ca](http://www.logiflex.ca). Our quotations department will study your request and send you a quotation and a technical drawing for approval as soon as possible. Modifications to quotations or technical drawings can be requested the same way. The approved quotation(s) and technical drawing(s) can then be attached to your purchase order.

### Orders

An official purchase order must be issued for all purchases. Your purchase order must contain the following information:

- Your company letterhead
- Your reference number
- The delivery address (with contact name and phone number)
- The complete product codes
- Furniture colour(s)
- Quantities
- Descriptions
- Retail prices and net prices
- Project registration number (if applicable), and your approved quotation and technical drawing (for special items).

Please note that a quotation cannot serve as a purchase order.

### Returns

All returns must first be approved by Logiflex. If the return is accepted, a Logiflex customer service representative will send you an official return authorization form in order to facilitate procedures between you, the carrier, and the Logiflex merchandise reception clerk. Additional costs for shipping or other expenses may be applied following any merchandise returns.

### Modifications and/or Cancellations

You have 24 hours from the time we acknowledge receipt of your order to make any requests for corrections or modifications. You may cancel your order during this same 24-hour period. If you would like to modify or cancel your order after this 24-hour verification period, please check with a Logiflex customer service representative. Orders cannot be changed or cancelled if production has already begun or if Logiflex has already received the raw materials.

### Liability

Logiflex's liability ends once the carrier has delivered all items in good condition. A delivery receipt signed by the customer acknowledges that the shipment is complete and has been received in good condition.

### Claims

Logiflex recommends inspecting the shipment before signing the carrier's delivery receipt. You must notify Logiflex of any incomplete shipments or damaged furniture as soon as possible. Requests to replace damaged products can be made via the "[Private Space](#)" section of our website, at [www.logiflex.ca](http://www.logiflex.ca). Our after-sales service department will examine your request and help you correct the situation.

### Changes

Logiflex reserves the right to make changes to the materials, accessories, components, specifications and designs, and to discontinue collections and/or models, at any time and without prior notice.

### Storage and/or Shipping Fees

According to the terms Logiflex set forth in the transport policy. The transport policy can be consulted online in the Private Space.

### Warranty

Logiflex guarantees to the original purchaser that Logiflex products are free from defects in design, materials and workmanship for the product's lifetime, with certain exceptions.

You may consult the full warranty on the website:

[Logiflex Warranty](#)

## How to Use the Price List

**Interactive Menu**  
 Product line: Alpha, Amigo, Axis  
 Product group: Task Seating  
 Product name: Alpha High Back Executive Chair  
 Product code: 1401

**Product image**  
 [Image of Alpha High Back Executive Chair]

**Illustrated options**  
 Options: Hard Floor Casters (Set of 5 casters), Seat Slider  
 Navigation Buttons (when blue): HF, SS

**Ordering instructions**  
 How to Order: 1401 E EXT A5 HF SS Fabric  
 Example: 1401 EXT A5 J. ENNIS ASTRAL 71

**Manufacturing Standards**  
 • EXT or E mechanism;  
 • A5 arms;  
 • Polyurethane foam;  
 • 5.5"H cylinder;  
 • Spider base in black (BA-25) with 5 soft floor casters.

**COM Fabric: number of yards required:**

Code	Total
1401	2

**Fabric combinations: use highest price range.**  
 Price upon request for different foam density or chair dimensions.

**Prices**

Code	COM					
	GR1	GR2	GR3	GR4	GR5	GR6
1401EXTA5	***	***	***	***	***	***
1401EA5	***	***	***	***	***	***

**Navigation buttons:** Previous View, Previous Page, Next Page, Product Map, Table of Contents

**Product-specific manufacturing standards**

**Additional Product Information and Notes**

**Product Code**

**Prices by Fabric Grade**

**Blue text hyperlink**

**Standard Product Code**  
 Details as per the price listed

**Options, if desired (\$)**  
 Always after the product code

## Appendix A: COM Fabric

### Upholstery Specification

Logiflex offers two options for upholstery specification:

Option 1 :	Customers may specify an upholstery from any supplier. Logiflex will then confirm upholstery grade and seat cost.
Option 2 :	Customers may select and purchase upholstery of their choice and ship upholstery to Logiflex (COM)

### Option 1 : Specified Upholstery

Customers may consult the websites of our principal suppliers to visualize their complete product range. It is then possible to consult the graded-in list available on Logiflex.ca to be informed of the appropriate Logiflex grade.

Website of the upholstery supplier gives essential information to the maintenance, availability, quality and performance of the selected upholstery. In all cases, the upholstery supplier's warranty will apply.

#### Information to provide with the order:

*Customer name*  
*Purchase order number*  
*Upholstery supplier name*  
*Pattern name/number*  
*Color name/number*  
*Number of yards to order*

#### Principal suppliers:

<i>Momentum Textiles</i>	<i>themomgroup.com</i>
<i>Ennis Fabrics</i>	<i>ennisfabrics.com</i>
<i>Maharam</i>	<i>maharam.com</i>
<i>Designtex</i>	<i>designtex</i>
<i>Mayer Fabrics</i>	<i>mayerfabrics.com</i>

#### See our Graded-In Program at:

[logiflex.ca/medias/documents/logiflex-graded-in.pdf](http://logiflex.ca/medias/documents/logiflex-graded-in.pdf)

### Option 2 : Customer's Own Material (COM)

Logiflex offers the option of providing your own upholstery. The price will be based on the cushion grade 1. The upholstery must be received three weeks prior to the acknowledged ship date. Delay in COM receiving may cause shipment to be delayed.

Customers have the option to provide Logiflex with a sample for approval prior the order. If no sample is sent for approval in advance, Logiflex is not responsible of any cost caused by unsuitable upholstery for the product or the production process. Furthermore, Logiflex reserves the right to refuse any upholstery that does not meet Logiflex selection criteria.

COM must be delivered to the Logiflex factory with freight and duties paid. All charges to COM acquisition on the customer's behalf will be passed onto the customer.

Logiflex does not assume responsibility for upholstery availability, quality, performance or appearance, the Logiflex warranty excludes customer's own materials.

#### COM upholstery delivery:

The following information must be included with the COM upholstery delivery and be communicated to the account manager along with the purchase order:

*Customer name*  
*Purchase order number*  
*Upholstery supplier name*  
*Pattern name/number*  
*Color name/number*  
*Number of yards delivered*

#### Shipping address:

Logiflex  
Attn: Receiver  
1235 St-Roch North Road  
Sherbrooke Quebec  
Canada J1N 0H2

**Note:** A late reception of fabric may cause delivery delays.



## Appendix B: COM Fabric (continued)

### Seams

Different top stitchings are available for different armchair models.

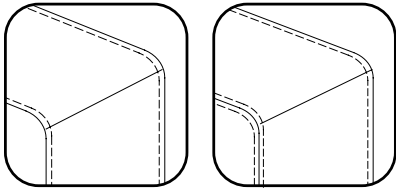

POS

Single Top Stitch

POD

Double Top Stitch

### Combining Fabrics

Different fabrics can be specified for the bench, back and privacy panel of the same seat at no extra cost.



**Example:**

Bench: ENNIS / ORNAMENTAL / #302 GR3;  
Back: ENNIS / BALANCE / #9009 GR1.

The price will be that of the highest-grade fabric chosen.

### Fabric Quantities

The quantities of fabric yardage to order for each piece of furniture is indicated in the "Manufacturing Standard" section on the product page indicating the amount of yards required.

Where this option is available, you will see the following table in the "Manufacturing Standard" section on the product page indicating the amount of yards required:

Example:

#### COM Fabric:

Fabric combination possible. Number of yards required:

Code	Total	Bench	Back	Panel
BDFP	7	2.5	2	2.5
BMFP	7.5	2.5	2.5	2.5
BHFP	8.5	2.5	3.5	2.5

**Note:** It is recommend that you include a layout with all orders.

### Graded-In List

Seat cost depends of selected upholstery. Grade is not established according to upholstery quality or performance, but to its purchase cost. In order to help customers researches, a graded-in list presenting the entire collections of Logiflex's principal suppliers has been prepared. It is possible to consult Logiflex graded-in list by visiting [logiflex.ca](http://logiflex.ca)

Note: The graded-in list is based on information at time of the publication of this document. As upholstery suppliers can discontinue products or increase their prices at their discretion, this list communicated for information purposes only and can not be considered as a sale commitment by Logiflex.

### Application of Upholstery

Application of upholstery will follow the directional orientation of its pattern. Explicit instructions must be given to the customer's account manager if a specific direction is desired. Logiflex will not be responsible of problems related to upholstery direction or positioning unless formal instructions has been given along with the purchase order.

Instruction references:

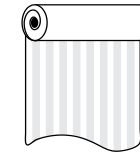

Up the Roll

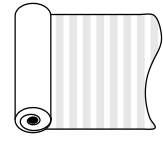

Railroaded  
(across the roll)

### Leather

All leathers used are "cowhide".

Please note that the warranty does not apply on leather's natural imperfections, such as: scars, marks, and difference in stain within a leather skin or different skins. This specification also applies for standard leather GR5 and Italian leather GR7 and up.

### Polyurethane foam

The polyurethane foam used in the manufacturing of our armchairs is antibacterial.

Different densities exist and will vary from one armchair model to the other. Medium-density foam is used for back and seating parts, while the firmer-density foam is used for armrest parts.

### Flammability standards

The foam used meets or exceeds the flammability standards of the California Technical Bulletin 117 norms.

---

# Task Seating

# Task Seating

## Alpha High Back Executive Chair

1401

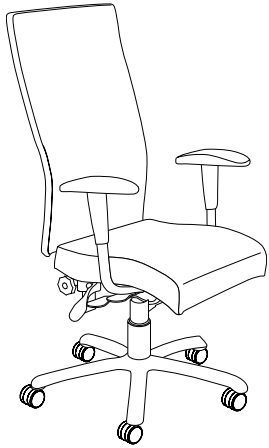

### Manufacturing Standards

- Polyurethane foam back and seat;
- EXT mechanism (4 function tilt mechanism);
- E mechanism (5 function tilt mechanism);
- A5 height adjustable arms;
- 5.5"H cylinder;
- Spider base in black (BA-25) with 5 soft floor casters.

**COM Fabric:** number of yards required:

Code	Total	Seat	Backrest
1401	2.25	.75	2

**Fabric combinations:** use highest price range.

Price upon request for different foam density or chair dimensions.

### Options

#### Hard Floor Casters

(Set of 5 casters)



\$33

#### Seat Slider

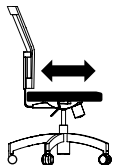

\$68

### Prices

Code	COM					
	GR1	GR2	GR3	GR4	GR5	GR6
1401EXTA5	864	939	1025	1116	1283	1410
1401EA5	899	976	1062	1153	1320	1445

### How to Order

				+				
		E EXT	HF SS		Fabric <i>See the Logiflex Graded-in List</i>			
CH	1401	A5	HF	SS				
series	model	mechanism	casters	seat slider	supplier	pattern	color	
<b>Example</b>	<b>CH</b>	<b>1401</b>	<b>EXT</b>	<b>A5</b>	<b>ENNIS</b>	<b>ASTRAL</b>	<b>71</b>	

# Task Seating

## Alpha Mid Back Executive Chair

1404

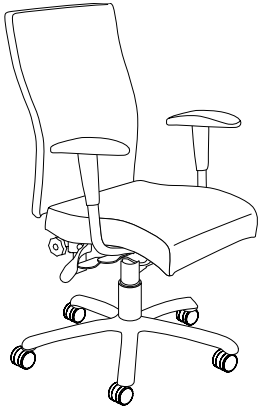

### Manufacturing Standards

- Polyurethane foam back and seat;
- EXT mechanism (4 function tilt mechanism);
- E mechanism (5 function tilt mechanism);
- A5 height adjustable arms;
- 5.5"H cylinder;
- Spider base in black (BA-25) with 5 soft floor casters.

**COM Fabric:** number of yards required:

Code	Total	Seat	Backrest
1404	2.25	.75	1.75

**Fabric combinations:** use highest price range.

Price upon request for different foam density or chair dimensions.

### Options

#### Hard Floor Casters

(Set of 5 casters)



\$33

#### Seat Slider

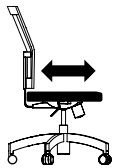

\$68

### Prices

Code	COM					
	GR1	GR2	GR3	GR4	GR5	GR6
1404EXTA5	818	893	972	1060	1218	1338
1404EA5	855	928	1008	1095	1255	1338

### How to Order

				+				
CH	1404	E EXT	A5	HF	SS	Fabric <i>See the Logiflex Graded-in List</i>		
series	model	mechanism	arm	casters	seat slider	supplier	pattern	color
<b>Example</b> CH	1404	EXT	A5			ENNIS	ASTRAL	71

# Task Seating

## Amigo Low Back Operator Chair

1804A0

1804

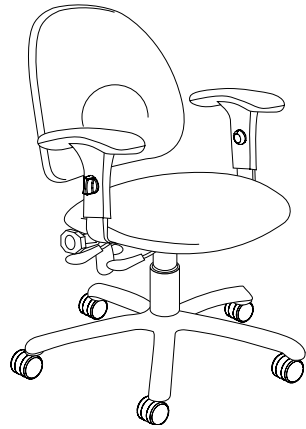
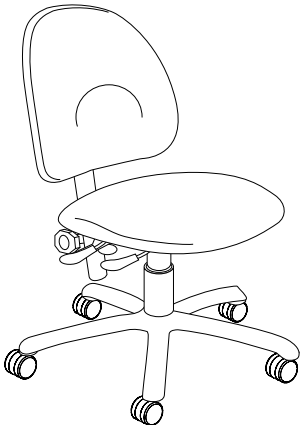

### Manufacturing Standards

- Polyurethane foam back and seat;
- EXT mechanism (4 function tilt mechanism);
- G mechanism (3 function tilt mechanism);
- A5 or A5F height adjustable arms;
- 3"H cylinder;
- Spider base in black (BA-25) with 5 soft floor casters.

**COM Fabric:** number of yards required:

Code	Total	Seat	Backrest
1804	1.5	.75	.75

**Fabric combinations:** use highest price range.

Price upon request for different foam density or chair dimensions.

### Options

#### Hard Floor Casters

(Set of 5 casters)



\$33

#### Seat Slider

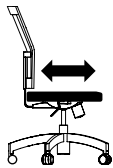

\$68

### Prices

Code	COM					
	GR1	GR2	GR3	GR4	GR5	GR6
1804GA0	455	492	531	596	839	916
1804EXTA0	573	612	649	715	944	1020
1804GA5F	564	601	640	704	934	1011
1804EXTA5	682	721	758	823	1038	1116

### How to Order

CH	1804	G EXT	A0 A5 A5F	HF	SS	Fabric <i>See the Logiflex Graded-in List</i>		
series	model	mechanism	arm	casters	seat slider	supplier	pattern	color
<b>Example</b>	<b>CH</b>	<b>1804</b>	EXT	A5		ENNIS	ASTRAL	71

# Task Seating

## Amigo Low Back Bar Stool Chair

1804A0ST

1804ST

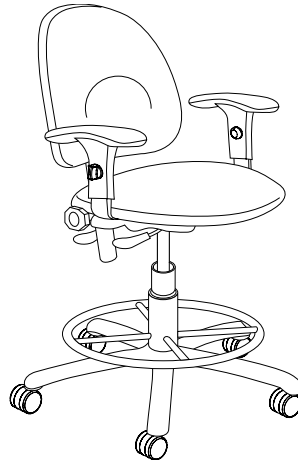
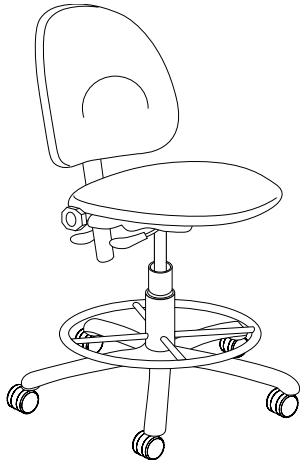

### Manufacturing Standards

- Polyurethane foam back and seat;
- EXT mechanism (4 function tilt mechanism);
- G mechanism (3 function tilt mechanism);
- A5 or A5F height adjustable arms;
- 10"H cylinder;
- Foot rest, 20" diameter;
- Spider base in black (BA-25) with 5 soft floor casters.

**COM Fabric:** number of yards required:

Code	Total	Seat	Backrest
1804 ST	1.5	.75	.75

**Fabric combinations:** use highest price range.

Price upon request for different foam density or chair dimensions.

### Options

#### Hard Floor Casters

(Set of 5 casters)



\$33

#### Seat Slider

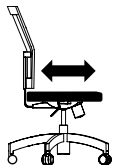

\$68

### Prices

Code	COM					
	GR1	GR2	GR3	GR4	GR5	GR6
1804GA0ST	632	671	709	773	996	1071
1804EXTA0ST	719	756	792	854	1099	1176
1804GA5FST	709	746	782	843	1090	1167
1804EXTA5ST	823	861	897	957	1194	1272

### How to Order

CH	1804	G EXT	A0 A5 A5F	ST20	HF	SS	Fabric <i>See the Logiflex Graded-in List</i>		
series	model	mechanism	arm	foot rest	casters	seat slider	supplier	pattern	color
<b>Example</b>	<b>CH</b>	<b>1804</b>	<b>EXT</b>	<b>A5</b>	<b>ST20</b>		<b>ENNIS</b>	<b>ASTRAL</b>	<b>71</b>

# Task Seating

## Axis Mid Back Operator Chair

201



### Manufacturing Standards

- Fabric mesh backrest with adjustable lumbar support;
- Polyurethane foam seat;
- PL mechanism (5 function tilt mechanism);
- A5F height adjustable arms;
- 3"H cylinder;
- Spider base in black (BA-25) with 5 soft floor casters.

**COM Fabric:** number of yards required:

Code	Total
201	1

Price upon request for different foam density or chair dimensions.

### Options

#### Hard Floor Casters

(Set of 5 casters)



\$33

### Prices

Code	COM					
	GR1	GR2	GR3	GR4	GR5	GR6
201EFA5F	910	956	1002	1054	1105	1181

### How to Order

				+			
<b>CH</b>	<b>201</b>	<b>PL</b>	<b>A5F</b>	HF	<b>Fabric</b> <i>See the Logiflex Graded-in List</i>		
series	model	mechanism	arm	casters	supplier	pattern	color

**Example** CH 201 PL A5F ENNIS ASTRAL 71

# Task Seating

## Axis Mid Back Operator Chair

201APT



### Manufacturing Standards

- Fabric mesh backrest with adjustable lumbar support;
- Headrest;
- Polyurethane foam seat;
- PL mechanism (5 function tilt mechanism);
- A5F height adjustable arms;
- 3"H cylinder;
- Spider base in black (BA-25) with 5 soft floor casters.

**COM Fabric:** number of yards required:

Code	Total
201APT	1

Price upon request for different foam density or chair dimensions.

### Options

#### Hard Floor Casters

(Set of 5 casters)



\$33

### Prices

Code	COM					
	GR1	GR2	GR3	GR4	GR5	GR6
201APTEFA5F	976	1022	1068	1121	1172	1247

### How to Order

CH	201	APT	PL	A5F	HF	Fabric <i>See the Logiflex Graded-in List</i>		
series	model	headrest	mechanism	arm	casters	supplier	pattern	color
CH	201	APT	PL	A5F	HF	ENNIS	ASTRAL	71

Example



# Task Seating

## Cyrus Mid Back Operator Chair

500YM

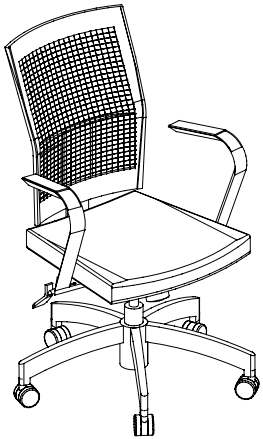

### Manufacturing Standards

- Fabric mesh backrest with adjustable lumbar support;
- Polyurethane foam seat;
- YM8340 mechanism (2 function tilt mechanism);
- A7 fixed aluminum arms;
- Spider base in black (SB) with 3" cylinder or aluminum (AB) with 5.5" cylinder;
- 5 HF hard floor casters.

**COM Fabric:** number of yards required:

Code	Total
500YM	1

Price upon request for different foam density or chair dimensions.

### Prices

Code	COM					
	GR1	GR2	GR3	GR4	GR5	GR6
500YM8340A7SB	624	660	705	749	795	839
500YM8340A7AB	664	701	748	793	838	884

### How to Order

CH	500	YM8340	A7	SB AB	HF	Fabric <i>See the Logiflex Graded-in List</i>		
series	model	mechanism	arm	base	casters	supplier	pattern	color
CH	500	YM8340	A7	SB	HF	ENNIS	ASTRAL	71

Example

# Task Seating

## Cyrus Mid Back Operator Chair

500EF

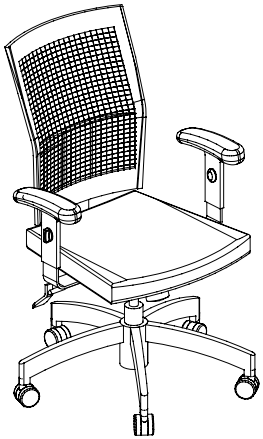

### Manufacturing Standards

- Fabric mesh backrest with adjustable lumbar support;
- Polyurethane foam seat;
- EF mechanism (5 function tilt mechanism);
- A5F height adjustable arms;
- Spider base in black (SB) with 3" cylinder or aluminum (AB) with 5.5" cylinder;
- 5 HF hard floor casters.

**COM Fabric:** number of yards required:

Code	Total
500EF	1

Price upon request for different foam density or chair dimensions.

### Options

#### Seat Slider

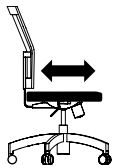

\$68

### Prices

Code	COM					
	GR1	GR2	GR3	GR4	GR5	GR6
500EFA5FSB	747	783	828	873	918	964
500EFA5FAB	789	827	872	918	964	1009

### How to Order

				SB AB		SS			
<b>CH</b>	<b>500</b>	<b>EF</b>	<b>A5F</b>		<b>HF</b>				
series	model	mechanism	arm	base	casters	seat slider	supplier	pattern	color

**Example** CH 500 EF A5F SB HF ENNIS ASTRAL 71

**Fabric**  
*See the Logiflex Graded-in List*

# Task Seating

## Cyrus Mid Back Operator Chair

500EXT

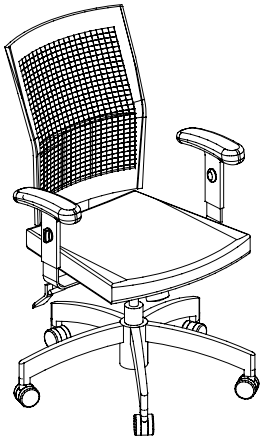

### Manufacturing Standards

- Fabric mesh backrest with adjustable lumbar support;
- Polyurethane foam seat;
- EXT mechanism (4 function tilt mechanism);
- A5 height adjustable arms;
- Spider base in black (SB) with 3" cylinder or aluminum (AB) with 5.5" cylinder;
- 5 HF hard floor casters.

**COM Fabric:** number of yards required:

Code	Total
500EXT	1

Price upon request for different foam density or chair dimensions.

### Options

#### Seat Slider

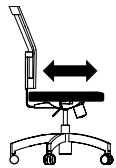

\$68

### Prices

Code	COM					
	GR1	GR2	GR3	GR4	GR5	GR6
500EXTA5SB	782	818	864	908	953	1000
500EXTA5AB	826	862	908	954	1000	1046

### How to Order

CH	500	EXT	A5	SB AB	HF SS	Fabric <i>See the Logiflex Graded-in List</i>			
series	model	mechanism	arm	base	casters	seat slider	supplier	pattern	color
<b>Example</b> CH	500	EXT	A5	SB	HF		ENNIS	ASTRAL	71

# Task Seating

## Cyrus Mid Back Operator Chair

500E

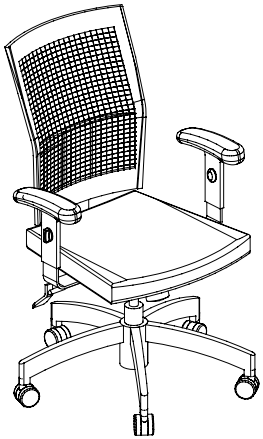

### Manufacturing Standards

- Fabric mesh backrest with adjustable lumbar support;
- Polyurethane foam seat;
- E mechanism (5 function tilt mechanism);
- A5 height adjustable arms;
- Spider base in black (SB) with 3" cylinder or aluminum (AB) with 5.5" cylinder;
- 5 HF hard floor casters.

**COM Fabric:** number of yards required:

Code	Total
500E	1

Price upon request for different foam density or chair dimensions.

### Options

#### Seat Slider

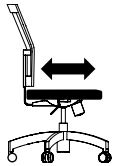

\$68

### Prices

Code	COM					
	GR1	GR2	GR3	GR4	GR5	GR6
500EA5SB	889	929	977	1026	1076	1123
500EA5AB	853	889	934	979	1024	1069

### How to Order

					SB AB	SS			
<b>CH</b>	<b>500</b>	<b>E</b>	<b>A5</b>				<b>HF</b>		
series	model	mechanism	arm	base	casters	seat slider	supplier	pattern	color

**Example** CH 500 E A5 SB HF ENNIS ASTRAL 71

## Suavo Low Back Visitor Chair

702

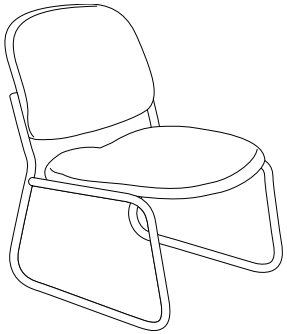

### Manufacturing Standards

- Polyurethane foam back and seat;
- Sled base.

**COM Fabric:** number of yards required:

Code	Total	Seat	Backrest
702	1.5	1	.75

**Fabric combinations:** use highest price range.

Price upon request for different foam density or chair dimensions.

### Prices

Code	COM			
	GR1	GR2	GR3	GR4
702	411	447	490	532

### How to Order

**Fabric**  
See the Logiflex Graded-in List

CH	702			
series	model	supplier	pattern	color

**Example** CH 702 ENNIS ASTRAL 71

## Suavo Low Back Visitor Chair

703

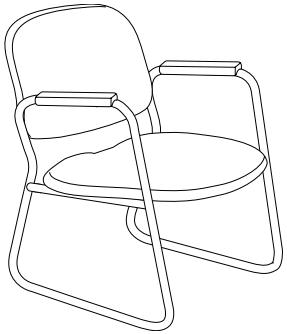

### Manufacturing Standards

- Polyurethane foam back and seat;
- Arm w/ black polyurethane pad;
- Sled base.

**COM Fabric:** number of yards required:

Code	Total	Seat	Backrest
703	1.5	1	.75

**Fabric combinations:** use highest price range.

Price upon request for different foam density or chair dimensions.

### Prices

Code	COM			
	GR1	GR2	GR3	GR4
703	450	489	532	581

### How to Order

**Fabric**  
See the Logiflex Graded-in List

CH	703			
series	model	supplier	pattern	color

**Example** CH 703 ENNIS ASTRAL 71

---

Accessories

# Accessories

## Mechanisms

### E

Mechanism

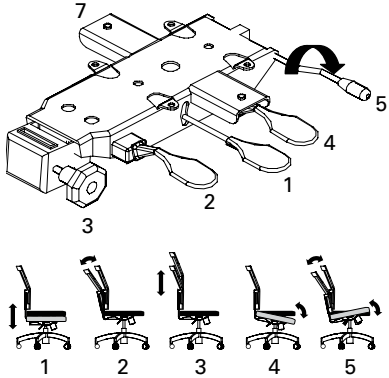

1. Pneumatic height adjustment;
2. Adjustable backwards tilt lever for back rest;
3. Manual back height adjustment;
4. Adjustable forward tilt lever;
5. Adjustable seat angle lever (rotational lever);
6. Manual tension adjustment (pressure handle found under mechanism);
7. Adjustable arms installation brackets.

Code	\$	Description
E	190	

### EF

Mechanism

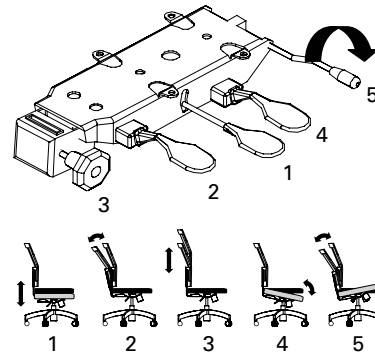

1. Pneumatic height adjustment;
2. Adjustable backwards tilt lever for back rest;
3. Manual back height adjustment;
4. Adjustable forward tilt lever;
5. Adjustable seat angle lever (rotational lever);
6. Manual tension adjustment (pressure handle found under mechanism).

Code	\$	Description
EF	184	

### EXT

Mechanism

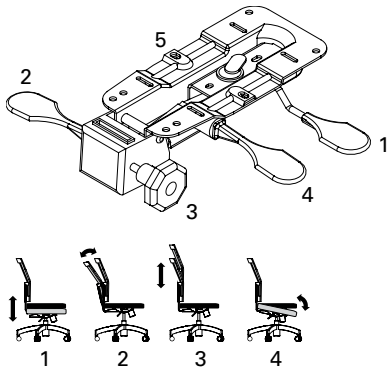

1. Pneumatic height adjustment;
2. Adjustable backwards tilt lever for back rest;
3. Manual back height adjustment;
4. Adjustable seat angle lever;
5. Brackets to receive adjustable arms.

Code	\$	Description
EXT	158	

### PL

Mechanism

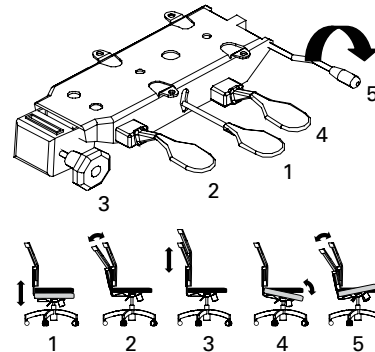

1. Pneumatic height adjustment;
2. Adjustable backwards tilt lever for back rest;
3. Manual back height adjustment;
4. Adjustable forward tilt lever;
5. Adjustable seat angle lever (rotational lever);
6. Manual tension adjustment (pressure handle found under mechanism).

Code	\$	Description
PL	184	



## Mechanisms

### G

Mechanism

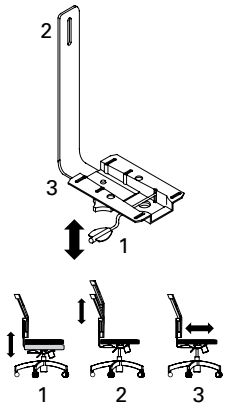

1. Pneumatic height adjustment (up and down movement);
2. Manual back height adjustment;
3. Manual depth adjustment.

Code	\$	Description
G	64	

### YM8340

Mechanism

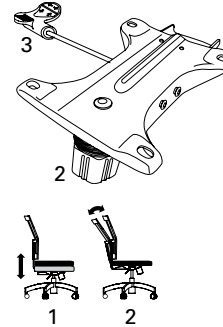

1. Manual height adjustment by gaz cylinder;
2. Manual tension adjustment;
3. Lever for the tilt lock.

Code	\$	Description
YM8340	75	

### GTL-M

Mechanism

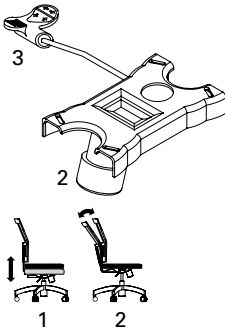

1. Manual height adjustment by gaz cylinder (GTL-M);
2. Manual tension adjustment;
3. Lever for the tilt lock;
4. Fixed back.

Code	\$	Description
GTL	75	

# Accessories



## Arms

### A5

Arm

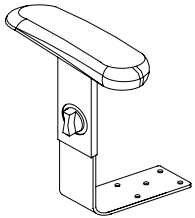

- 2 Arms with adjustable height and width;
- Black polyurethane pad;
- For mechanisms E and EXT.

Code	\$	Description
A5	100	

### A61

Arm

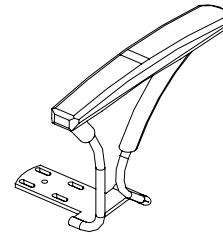

- 2 fixed T-Arms;
- Black polyurethane pad;
- For mechanisms EF and YM.

Code	\$	Description
A61	100	

### A5F

Arm

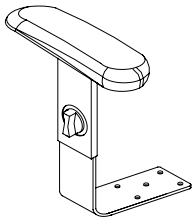

- 2 Arms with adjustable height and width;
- Black polyurethane pad;
- For mechanisms EF, G, GTL-M and YM.

Code	\$	Description
A5F	100	

### A7

Arm

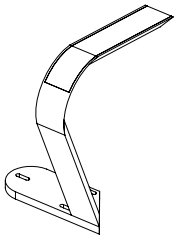

- 2 fixed aluminum arms;
- Black polyurethane cover;
- For mechanisms EXT and YM.

Code	\$	Description
A7	100	

# Accessories

## Miscellaneous Accessories

### HF

Hard Floor Caster

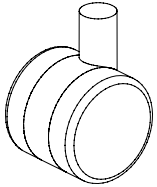

- Set of 5 hard floor casters.

Code	\$	Description
HF	33	

### SS

Seat Slider

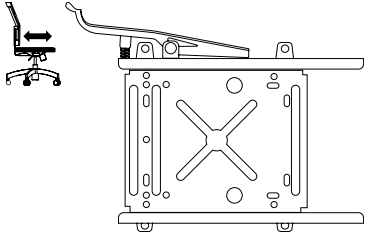

- Manual depth adjustment.

Code	\$	Description
SS	68	



As our product line is constantly evolving and expanding, we recommend that you visit [logiflex.ca](http://logiflex.ca) for updates.

logiflex

1235 St-Roch N., Sherbrooke QC J1N 0H2 Canada  
T : 1.877.864.9323 | F : 1.800.474.7830 | [logiflex.ca](http://logiflex.ca)