

# Typical Layouts

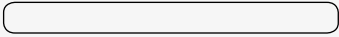

xtension-c031

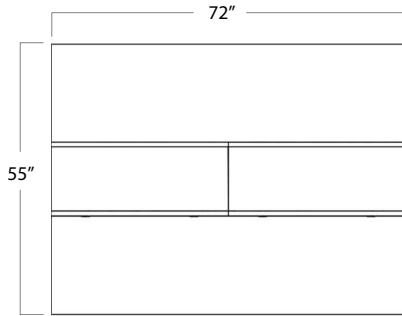

Laminate: Vega  
 Wood: Bark  
 Metal: White

**Note:** Fabrics are specified for informational purpose only and may be of different grades.

ITEM	QTY	CODE	DESCRIPTION	PRICE LIST \$	TOTAL \$
	2	XT 153642 USF	Island Station 15 X 36 X 42H	843	1 686
A	2	[PLR]	Option - Cutout for socket, left and right	0	0
B	1	XT 2072 TOP SPN	Rectangular surface 20 X 72	231	231
				Total:	1 917

**Accessories**

C	4	RAW WH	Leg, white metal	181	724
	4	[BK]	Option - Wood color Bark	0	0
D	2	CNT01 SN	Cantilever support	56	112
E	4	CNTC01 WH	Slender cantilever support	25	100
F	1	IGS	Installation guide for surface supports	127	127
				Total:	1 063

**Electrical Accessories**

	4	SQE-120-C	Electric plug, black	135	540
	4	SQU-72-C	USB port, black	222	888
	1	BE-PI72	Plug-in start cable 72" 20A	226	226
	2	BE-KDHB-1-BL	1 double half power bloc with 2 black duplexes 1 circuit	203	406
	1	BE-J42	M/M jumper 42"	152	152
				Total:	2 212